

# A22 Rail Installation Guide

Language | Language  
Language | Language  
Language



**⚠ WARNING:** Whenever you need to lift the system, get others to assist you. To avoid injury, do not attempt to lift the system by yourself. Get others to assist you or use a mechanical lift.

**① NOTE:** Begin installing the rails in the allotted space that is closest to the bottom of the rack enclosure. It is intended for use in a data center or server room.

## 1 Identifying the rail kit contents

Language | Language | Language  
Language | Language

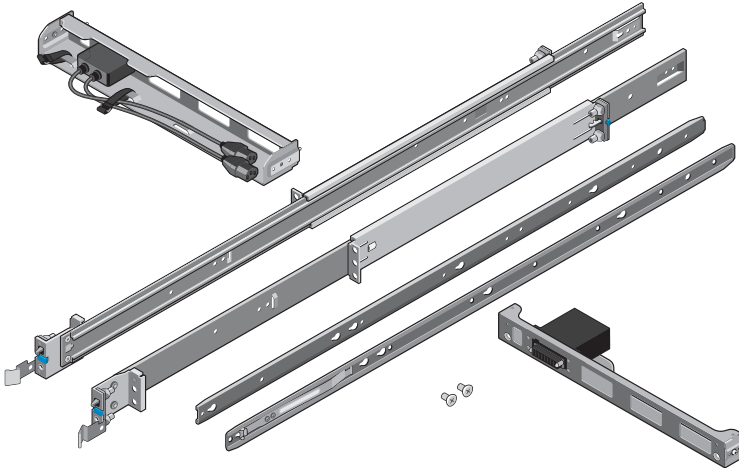

## 2 Installing the rail for systems with chassis ear hook feature (tool-less installation in square-hole and round-hole racks)

Language | Language  
Language | Language  
Language

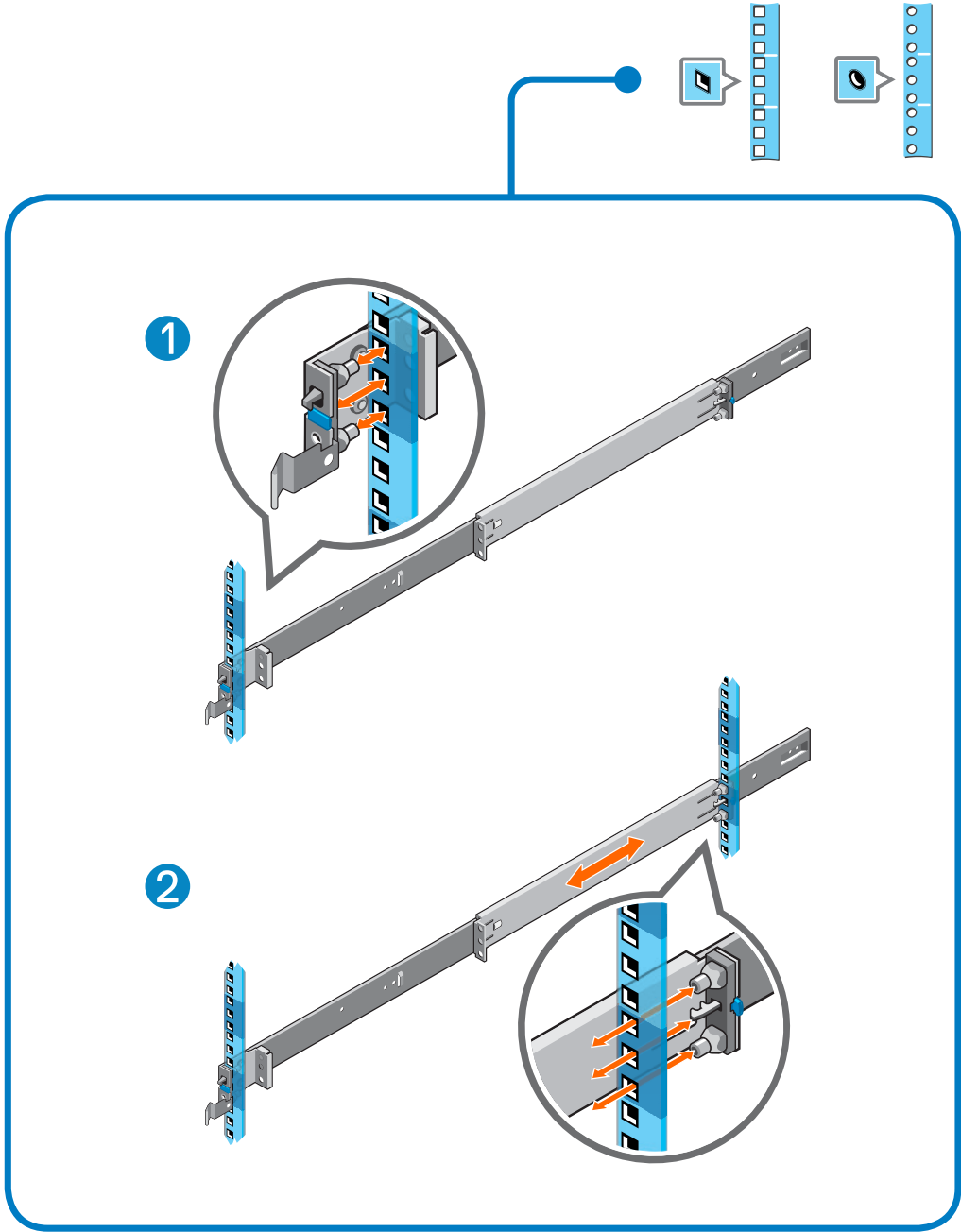

## Installing the rail for systems with chassis ear hook feature (tooled installation in threaded-hole racks)

Language | Language  
Language | Language  
Language

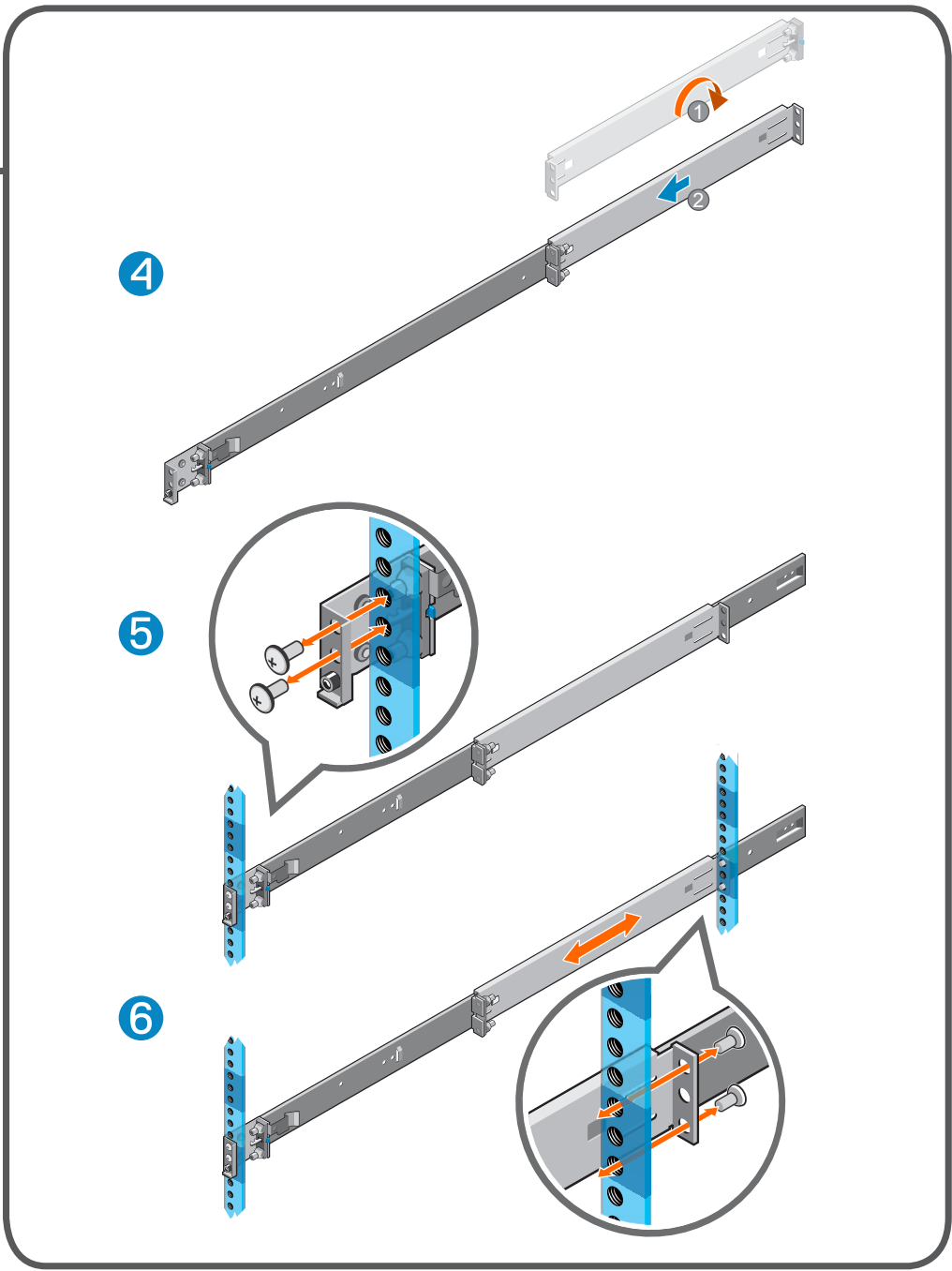
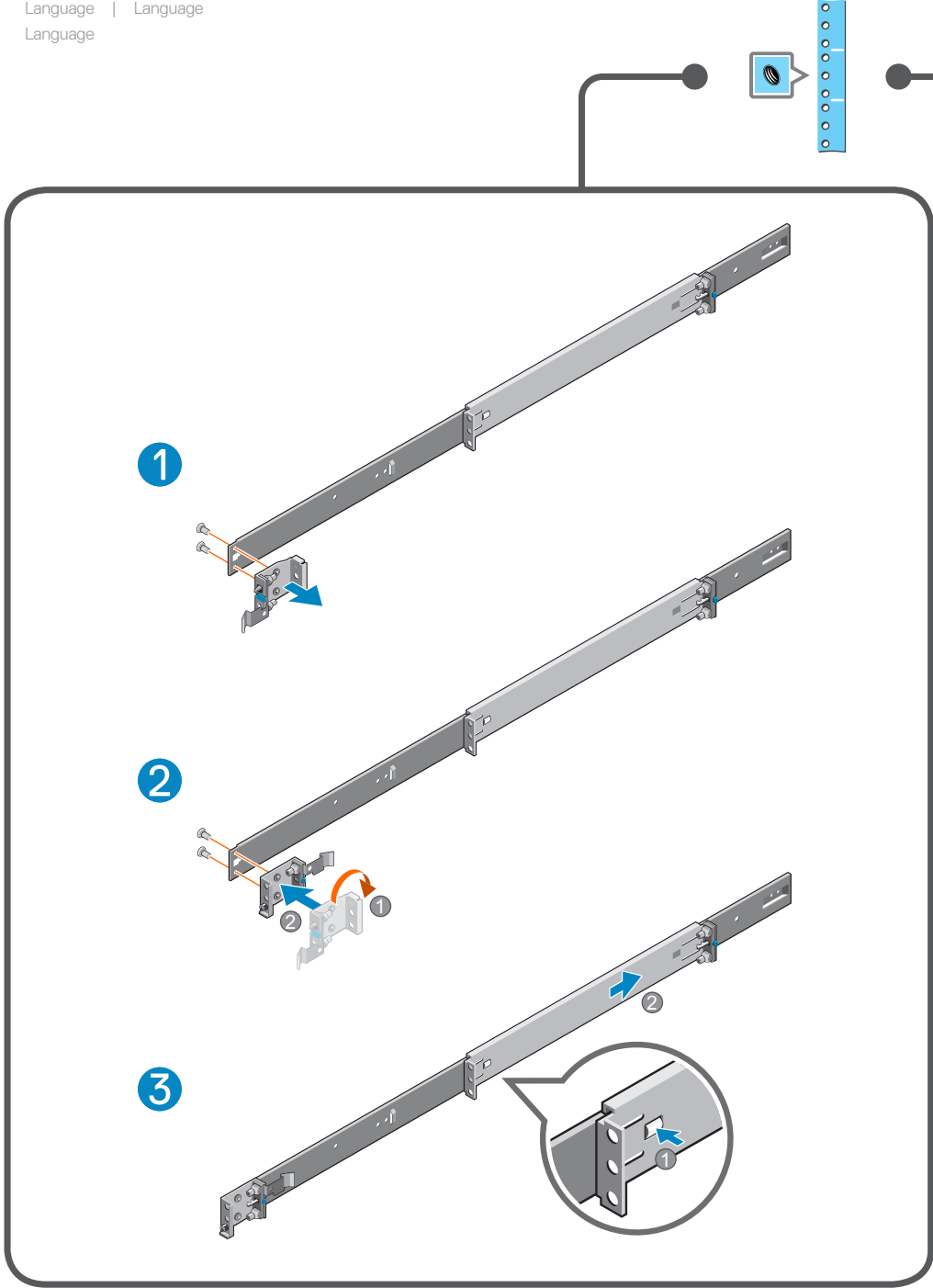

**3 Installing the system onto the rails**

Language  
Language  
Language  
Language  
Language

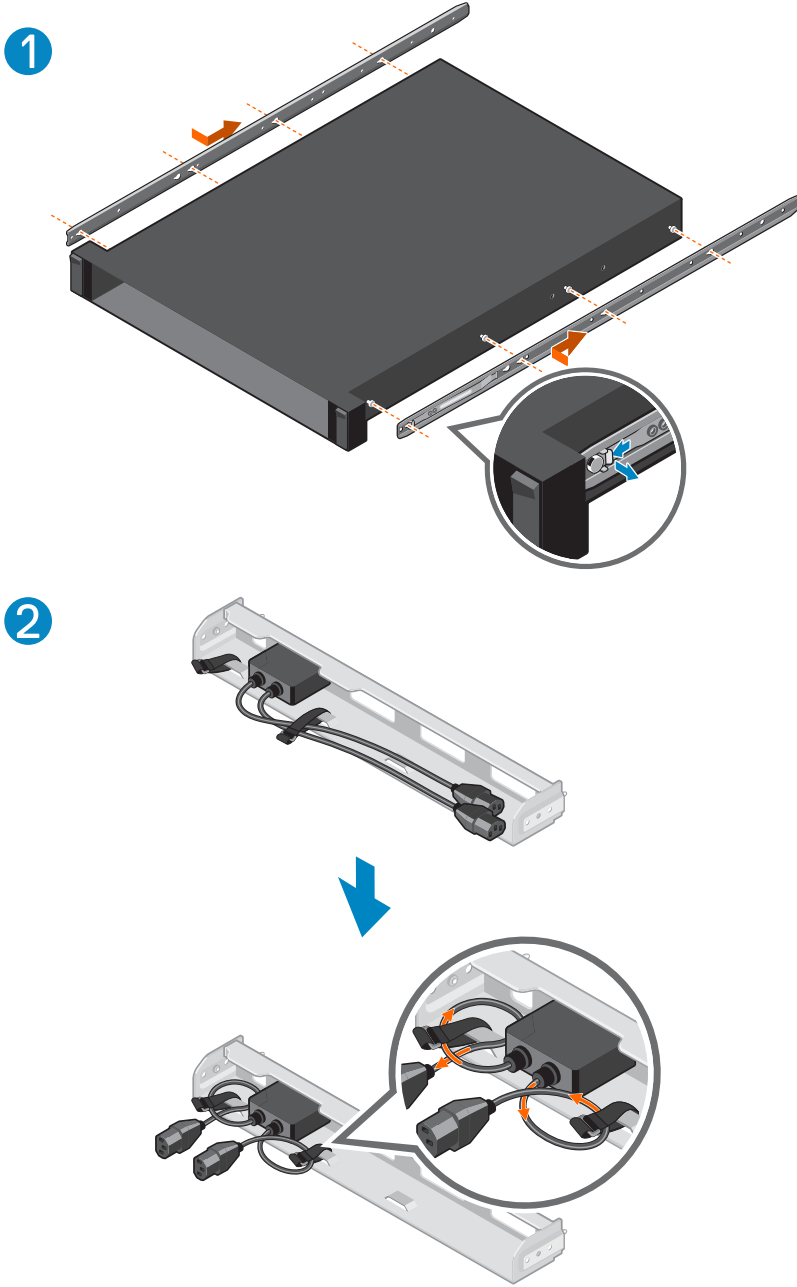

3

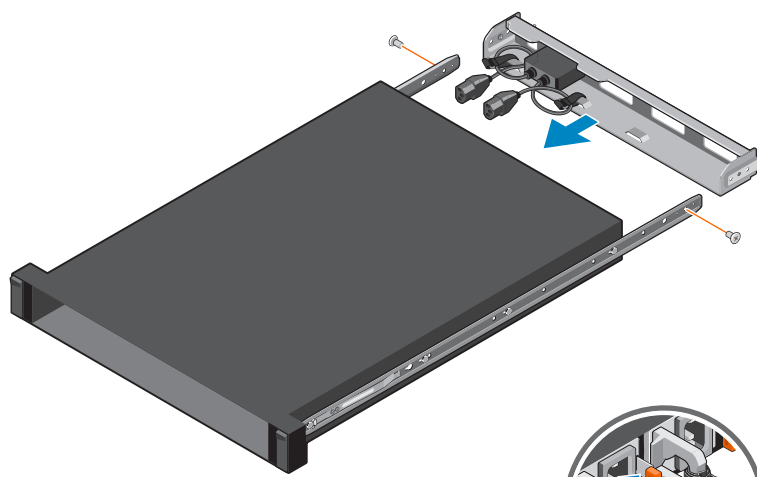

4

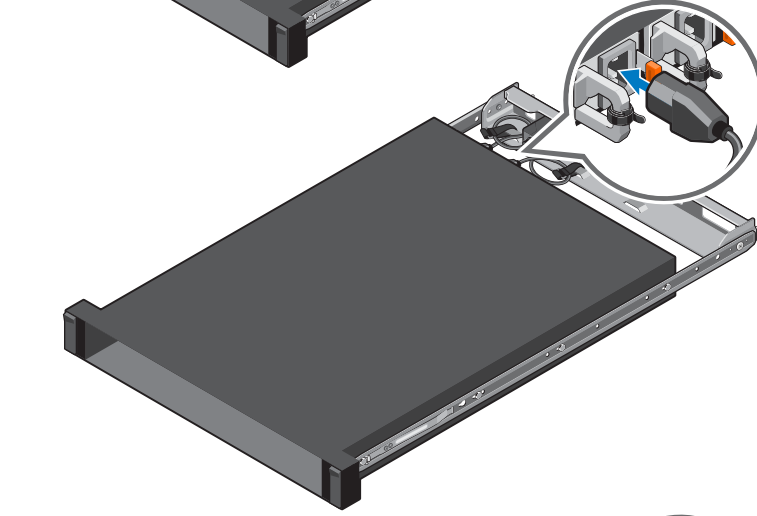

5

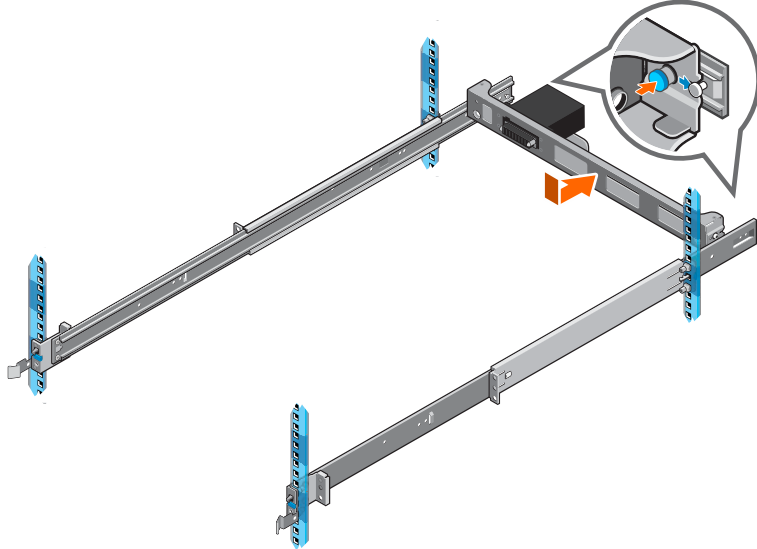

6

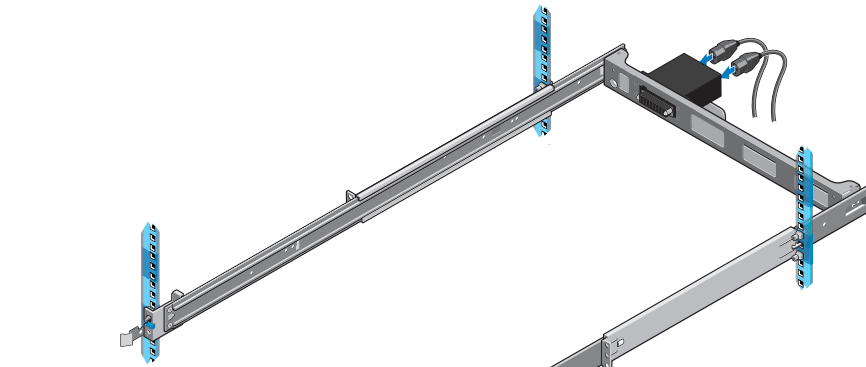

7

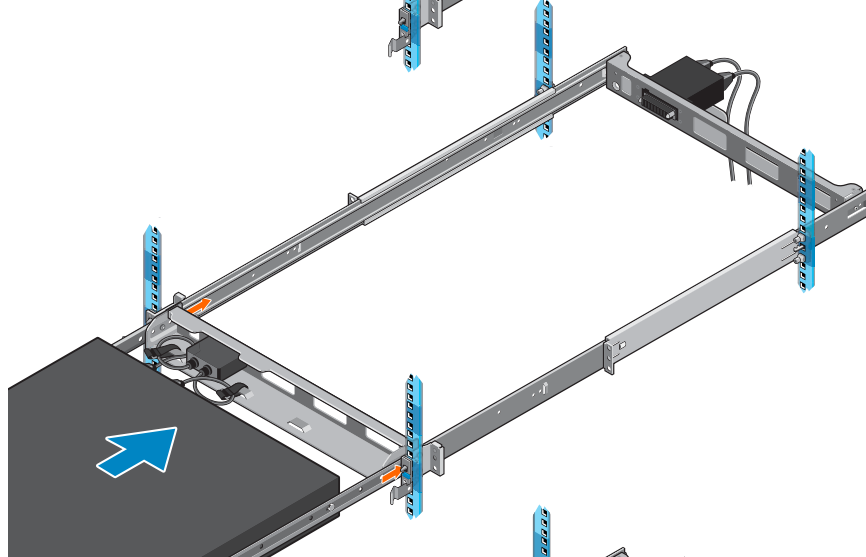

8

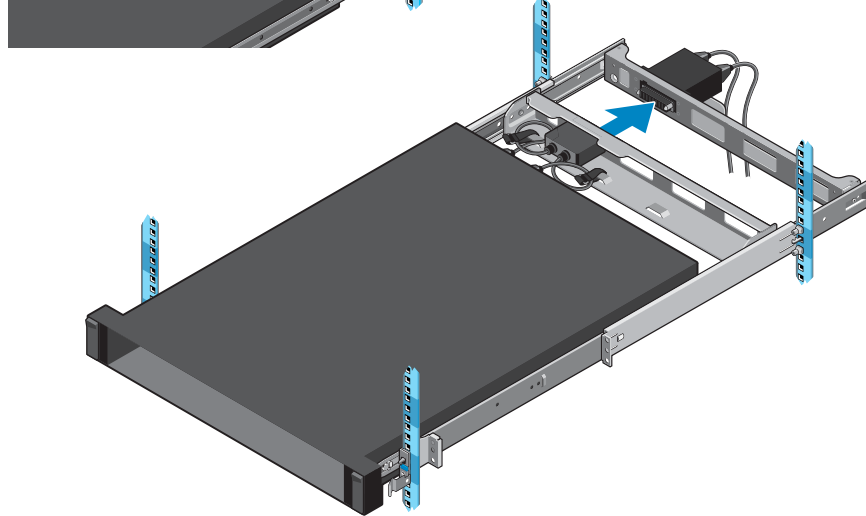

**4 Securing or releasing the system from the rails.**

Language  
Language  
Language  
Language  
Language

- ⚠ WARNING: Power off the system before removing it from the rack.**
- ① **NOTE:** To secure the system for shipment in the rack or in other unstable environments, locate the hard mount captive screw under each latch and tighten each screw using a Phillips #2 screwdriver.
- ⚠ WARNING: Power off the system before removing it from the rack.**
- ① **NOTE:** To secure the system for shipment in the rack or in other unstable environments, locate the hard mount captive screw under each latch and tighten each screw using a Phillips #2 screwdriver.

