

**DELL**Technologies

# Inspire innovation, transform learning.

---

Technology Solutions for Higher Education  
Students, Faculty and Administrators



# Higher Education use cases

---



## Collaborative Learning

PAGE 3

Provide unprecedented opportunities for students and faculty to meet, collaborate on projects, and exchange ideas — both in the classroom and around campus.



## Computer Labs

PAGE 4

Whether for general use or to gain access to software and applications that put students at the forefront of learning, computer labs provide access to critical resources.



## Faculty And Staff

PAGE 5

When faculty is equipped with the right devices, work is more efficient, time is better-managed, and day-to-day productivity is optimized.



## Students

PAGE 6

Students must be equipped with robust mobile technology that is powerful, durable and affordable.



## Vocational, Outdoor And Field Studies

PAGE 7

Give students an opportunity to apply their skills and knowledge in real-world environments and engage in hands-on learning.



## Esports and Gaming

PAGE 8

From competition to production to game design, Dell Technologies delivers end-to-end esports solutions to help students get in the game.



## Powering Learning with AI

PAGE 9

Enhance collaborative learning, faculty research and accessibility with Dell AI PCs.

# Solutions for Collaborative Learning

Revolutionize learning with powerful tools that allow students and faculty to meet and collaborate.



The Dell Pro 75 Plus 4K Touch Monitor brings students and instructors together for more collaboration and shared learning. Its large interactive touch screen supports brainstorming and problem-solving in classroom and study spaces, with the option to mount it on a movable cart for accessible use for students of all heights and mobility needs.

Integrate a Dell Micro desktop\* at the back of the monitor for an all-in-one solution that simplifies access to WiFi and applications.

\*Sold separately

## Dell Recommended Solution

- A Dell Pro 75 Plus 4K Touch Monitor - P7525QT
  - B Dell Pro Micro with the Dell Pro Micro All-in-One Stand - MFS22
- Logitech Room Solutions\* (Logitech Tap Room Touch Controller, Logitech Meetup2 Conference Cam, Logitech Rally Bar, Logitech Rally Mic Pod)



\* Not pictured

## Additional accessories and options

- C Dell Pro P 24 USB-C Hub Monitor - P2426HE
- D Dell Pro 24 All-in-One
- E Dell Pro 7 Slim Keyboard and Mouse - KM726



Some options may not be available in all regions.

# Solutions for Computer Labs

Computer labs ensure all students have equitable access to robust technology and applications, allowing students to excel in all areas and disciplines.

The versatile Dell Pro Slim is an ideal solution for any computer lab. Fully expandable, it allows administrators to customize the setup to adjust to students' needs. Upgrade to a Pro Precision desktop and touch-enabled monitor for more complex applications that support students in STEAM environments.

## Dell Recommended Solution

- A Dell Pro Slim or Dell Pro Slim Plus
- B Dell Pro P 24 Monitor
- C Dell Pro Slim All-in-One Stand - OSS25
- D Dell Pro 7 Slim Keyboard and Mouse - KM726

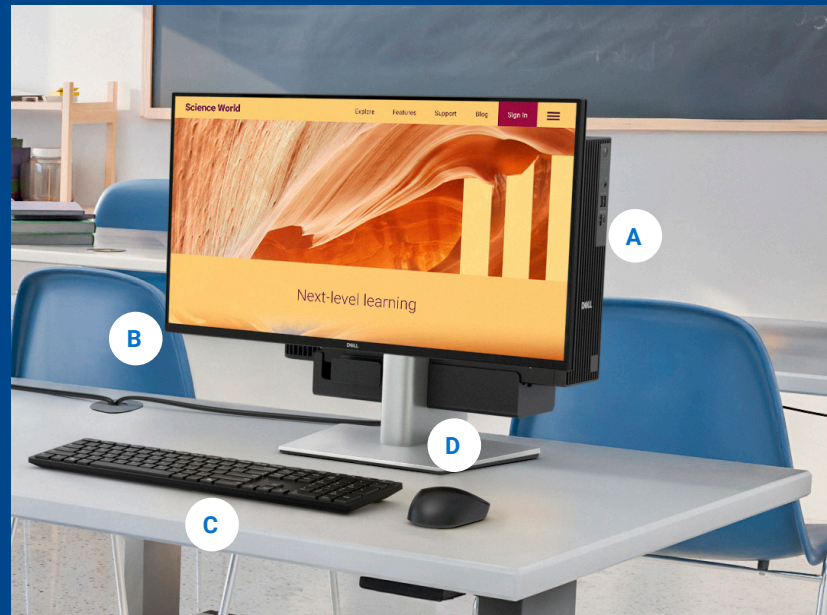

## Additional accessories and options

- E Dell Pro Precision 9 T2 Workstation  
An excellent choice that provides for scalable performance to fit the needs today and tomorrow.
- F Dell Pro 24 Plus Touch USB-C Hub Monitor - P2424HT

## Alternate solution for accessing virtual workspaces

Dell Pro Micro Thin Client, Dell Pro All-in-One or Dell Pro 14 configured with Dell ThinOS or Windows 11 IoT Enterprise.\*  
Get the centralized control and security inherent to Dell thin clients and secure access to cloud-based applications and virtual workspaces.

[Learn More >](#)

\* not pictured

# Solutions for Faculty and Staff

No matter where work takes you – from building to building, classroom to classroom, or campus to home, find the right solution that allows your office to be anywhere, anytime.



The new Dell Pro 7 laptops blend portability and performance to help you stay productive at home, on campus, or anywhere in between. As the thinnest laptops in the Dell Pro portfolio,\* they're easy to carry wherever your work takes you. You get smooth performance, exceptional battery life, and powerful on-device AI with Series 3 Intel® Core™ Ultra or AMD Ryzen™ AI PRO Series 400 processors. Select a 2-in-1 option to work in four different modes: laptop, tent, stand, or tablet.

## Dell Recommended Solution

- A** Dell Pro 7 13/14 Laptop or 2-in1
- B** Dell Pro 7 Rechargeable Compact Mouse - MS746
- C** Dell Pro Premium Active Pen – PN7522W

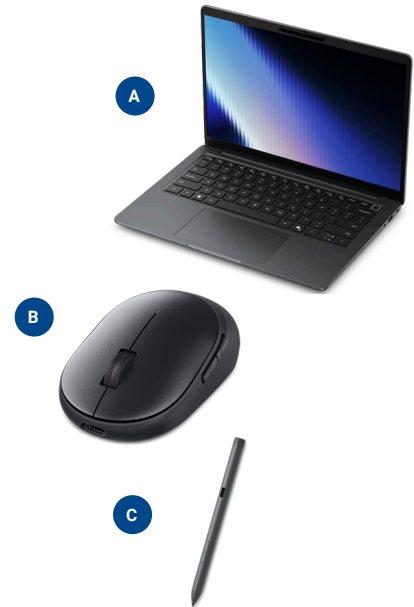

## Additional accessories and options

- D** Dell Pro P 27 USB-C Hub Webcam Monitor - P2726DEV
- E** Dell Pro Plus Earbuds - EB525
- F** Dell Pro Thunderbolt 5 Dock - WD25TB5
- G** Dell Pro Plus Wireless Speakerphone - SL525
- H** Dell Pro 14-16 Premium EcoLoop Slim Backpack – CP7625S

Some options may not be available in all regions

\*Based on internal analysis, February 2026.

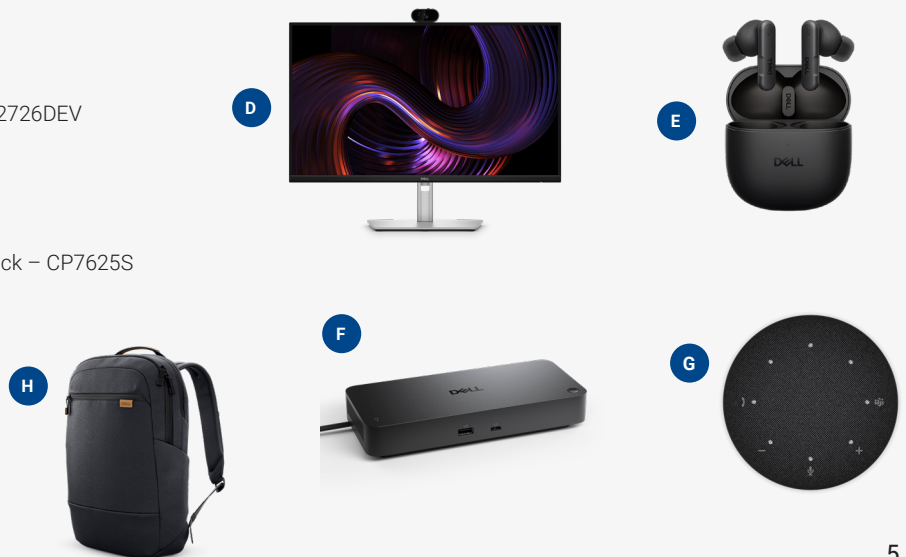

# Solutions for Students

Study and learn from anywhere with the right solution for students needing mobile devices for productivity wherever they work; including classrooms, libraries, coffee shops, study rooms, dorms, off campus apartments, and more.



## Dell Recommended Solution

For students who don't need IT manageability but still want impressive performance, the sleek Dell and XPS laptops blend sleek, modern design with cutting-edge AI-powered features. Available in 14-inch and 16-inch models, they offer all-day battery life, perfect for extended study sessions.

For a larger screen option, choose the Dell 16 Plus 2-in-1 for immersive productivity in a 16-inch screen.

**A** Dell XPS 14 or Dell XPS 16

**B** Dell 14 Plus or Dell 16 Plus

**C** Dell Pro 14 Plus Portable Monitor - P1425

**Additional accessories and options**

- D** Dell Pro Plus Earbuds - EB525
- E** Dell Travel Hub
- F** Dell Pro 7 Rechargeable Compact Mouse - MS746
- G** Dell Pro 14-16 Premium EcoLoop Slim Backpack – CP7625S

\*Not pictured  
Some options may not be available in all regions

# Solutions for Vocational, Outdoor and Field Studies

Using highly durable technology that thrives in the harshest of conditions, students can fully engage in their field of study. Faculty and on-campus police can benefit from robust tools and sturdy technology.



## Dell Recommended Solution

Dell Pro Rugged laptop and tablet, with durable chassis and direct sunlight-readable screen makes it easy for students, faculty and administrators to work on the go, in any environment, under any condition.

- A Dell Pro Rugged 12 Tablet
- B Detachable Keyboard
- C Rugged Active Pen



## Additional accessories and options

- D Carrying accessories like rigid handle, flexible handle and shoulder strap
- E Dell Mobile Battery Charger



\* Not pictured  
Some options may not be available in all regions

# Solutions for Esports and Gaming

End-to-end high-performance gaming ecosystems that can serve as a tool to help students engage in esports and develop skills needed for success.



## Dell Recommended Solution - Alienware

Alienware solutions efficiently designed for optimized performance and the technology to support all aspects of your program.

- A** Alienware Aurora desktop or Alienware Area-51 desktop\*
- B** Alienware Pro Wireless Gaming Keyboard
- C** Alienware Pro Wireless Gaming Mouse
- D** Alienware 25 320Hz Gaming Monitor - AW2525HM



### Additional accessories and options

- E** Alienware Pro Wireless Gaming Headset

For game design and development, Dell Precision Workstations are well suited in academic labs and classrooms.

\* Not pictured  
Some options may not be available in all regions



# Powering innovative learning experiences with AI



## COLLABORATIVE LEARNING

### AI Powered Group Projects

International students can easily collaborate with other multilingual students in group projects, with real-time language translation and transcription helping them focus on their academic work, rather than struggling with language barriers

*Tech Stack*

*AI PC* Dell XPS 14 or Dell 14 Plus

*AI Solution* Live Captions (Copilot+ PC Features)

## FACULTY RESEARCH

### Accelerating Discoveries

Researchers can accelerate complex data processing and quickly identify patterns, anomalies, and correlations in large datasets with High Performance AI PCs, used in fields like genomics, climate science, and medical research.

*Tech Stack*

*AI PC* Dell Pro Max 16

*AI Solution* MATLAB, TensorFlow

## ACCESSIBILITY

### Supporting Students with Disabilities

Enhance digital experiences in libraries and computer labs by enabling students with disabilities to interact with devices using voice commands or head motions, allowing independent navigation of digital learning tools and educational resources

*Tech Stack*

*AI PC* Dell Pro 13/14 Premium

*AI Solution* Cephable

# Dell Education Solutions

---

## Dell Technologies ProSupport for PCs

Work happens everywhere, all the time. And school IT teams don't need to just keep up, they need to stay ahead. With our advanced telemetry and AI, schools can remotely manage the health of their Dell fleet, anticipate, and resolve issues and automate PC updates. Smarter support with ProSupport Suite for PCs. Keep your students and faculty members happy and productive.

[Learn More about ProSupport for PCs ›](#)

## Dell Technologies Financial Services

Balancing educational budgets can be challenging, especially when upgrading to newer infrastructure and technologies across multiple classrooms and students. We provide flexible payment solutions with options for zero up-front costs and low monthly payments that allow you to align and scale cost of IT with your budget availability.

[Learn More about Dell Financial Services ›](#)

# Simplify IT

Our most secure<sup>1</sup> and most manageable<sup>2</sup> commercial PCs make IT management a breeze

## SECURITY

Improve fleet-wide security with multiple layers of defense.

Reduce the attack surface and enhance long-term cyber resilience with [Dell Trusted Workspace >](#)



Be secure from first boot with enhanced supply chain assurance through **Dell SafeSupply Chain**.



Reduce exposure to classical and quantum threats with deep, BIOS-level visibility via **Dell SafeBIOS and Dell Trusted Device App**.



Store credentials in hardware away from malware that looks to steal them with **Dell SafeID**.



Layer on advanced threat protection from our partner ecosystem: **CrowdStrike • Absolute • Halcyon**



**Shrink the IT-security gap with integrated hardware and software defenses.**

[Learn More >](#)

## MANAGEABILITY

**Best-in-class PCs and peripherals management – only from Dell.**

With **Dell Management Portal**, you can manage Dell PCs, over the cloud, in conjunction with Microsoft Intune. [Dell Management Portal >](#)

And with Dell Device Management Console, you can save time with centralized and secure peripherals management. [Dell Device Management Console >](#)

Update and secure your fleet of Dell devices, with one application– **Dell Client Device Manager**.

**Dell Trusted Update Experience** makes it simple to update endpoints with the latest BIOS and driver versions. Dell is the first Top 5 PC vendor to:



**Publish<sup>3</sup> a device drivers and downloads release schedule:**

IT Admins can deploy fleet-wide device updates on a predictable timeline.

[Learn More >](#)



**Dell has the industry's first:<sup>4</sup>**

Partner Portal accessible in Microsoft Intune, with fleet-wide BIOS password access capability and Enterprise application access and publication capabilities

Binary Large Object (BLOB) package-based solution, for endpoint BIOS settings configuration, using Microsoft Intune

# Simplify PC refresh with Dell Services

Transform technology for education into a competitive advantage with solutions that empower IT, boost productivity, and provide the agility to scale confidently. With proven expertise, AI-powered automation, and flexible financial models, we deliver measurable outcomes—freeing IT for innovation and helping organizations thrive through any challenge.

## Subscribe to PCs and services<sup>1</sup>

Fully customizable monthly subscription that can include PCs, peripherals, software and services with no upfront investment.

APEX PC as a Service makes it easy to refresh to the latest PCs and seamlessly deploy, secure, manage, support and help with the retirement of devices.

[Subscribe to PCs and services >](#)

## Deploy PCs with ease

PC refresh starts with getting new devices in the hands of your end-users. Dell ProDeploySuite for PCs streamlines operations and increases productivity with configured PCs that are ready to use on day one with dynamic cloud-based provisioning and imaging.

When transitioning from old to new technology, ProDeploy Plus includes the ability to securely erase sensitive end-user data with sophisticated tools to sanitize devices and includes Asset Recovery Services for responsible retirement.

[Deploy PCs with ease >](#)

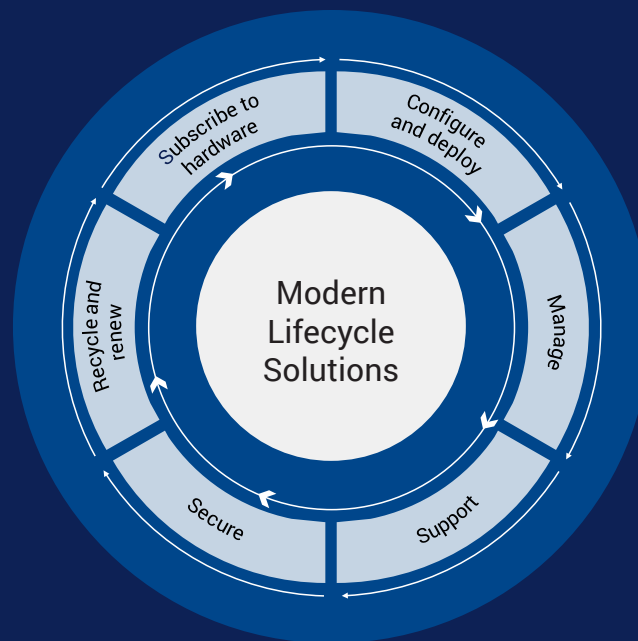

## Securely retire your devices

Let Dell help you securely and responsibly retire your old IT equipment — regardless of brand — to allow for a seamless transition from old to new technology, while protecting both your business and the planet.

[Securely retire your devices >](#)

## Simplify fleet management

The Dell Lifecycle Hub Suite (LCH) eases complexity in managing an organization's entire device fleet. It combines warehousing and inventory management with configuration services, repairs, returns and asset recovery into one solution that delivers a ready-to-work experience for end users with devices preconfigured to user personas. This frees up IT resources to focus on organization priorities and maximizes end-user device utilization over the full PC lifecycle.

[Watch Video >](#)

## Maximize uptime with intelligent, automated support

Dell ProSupport Suite for PCs is more than a 24/7 break-fix solution, it's a comprehensive set of tools that automate and optimize your environment with little to no human intervention or end-user disruption. IT teams can leverage telemetry-driven insights to make targeted updates, all controlled from a single dashboard. And with ProSupport Plus, you gain access to a robust library of Dell-authored scripts that automate tasks and resolve fleetwide issues at scale, minimizing downtime and maintaining peak system performance.

[Maximize uptime with intelligent, automated support >](#)

## Disclaimers

### Page No 11

1. Based on Dell internal analysis, October 2025 (Intel) and March 2026 (AMD). Applicable to PCs on Intel and AMD processors. Not all features available with all PCs. Additional purchase required for some features. Intel-based PCs validated by Principled Technologies, July 2025.
2. Based on Dell internal analysis, January 2025. Most-manageable commercial PCs when comparing the systems management capabilities of Dell Update Processes, Dell Manageability Solution capabilities and integrations with 3rd Party Management Solutions, with competitor update processes, systems management solution capabilities and integrations with 3rd party management solutions. 3rd Party Management Solution - Microsoft Intune, is a separate purchase.
3. Dell publishes a device drivers and downloads release schedule. Source: Based on internal analysis, May 2023. When comparing publicly available device drivers and downloads release schedules published by the Top 5 PC vendors, as of May 2023.
4. Capabilities of Dell Update Processes, Dell Management Portal and Dell Manageability Solutions capabilities and integrations with 3rd Party Management Solutions, with competitor update processes, partner portal capabilities in Microsoft Intune systems management solution capabilities and integrations with 3rd party management solutions. 3rd Party Management Solutions - Microsoft Intune, Workspace ONE, are separate purchases. Intel vPro, to support out-of-band systems management, is an additional system configuration upgrade; and Dell has the industry's first:
  - a. Based on Dell internal analysis - October 2024. Based on Dell Management Portal capabilities in Microsoft Intune compared to competitor Partner Portal capabilities in Microsoft Intune. Dell Command | Endpoint Configure for Microsoft Intune - the industry's first Binary Large Object (BLOB) package-based solution, for securely configuring & managing endpoints, using Microsoft Intune. Disclaimer: Industry's first device manageability solution to use a Binary Large Object (BLOB) package, recognized by Microsoft Intune, for secure endpoint configuration and management.
  - b. Dell Command | Intel vPro Out of Band- the industry's first hardware OEM systems management solution to integrate with Intel vPro - for remote management of systems, regardless of power-state. Disclaimer: Based on Dell internal analysis, November 2023.
  - c. Dell Command | Intel vPro Out of Band- the industry's first hardware OEM systems management solution to integrate with Intel vPro - for remote management of systems, regardless of power-state. Disclaimer: Based on Dell internal analysis, November 2023.

### Page No 12

1. Payment solutions provided and serviced by Dell Financial Services L.L.C. or its affiliate or designee ("DFS") for qualified customers. Offers may not be available or may vary in certain countries. Where available offers may be changed without notice and are subject to product availability, applicable law, credit approval, documentation provided by and acceptable to DFS and may be subject to minimum transaction size. Offers not available for personal, family or household use. Dell Technologies and the Dell Technologies logo are trademarks of Dell Inc. Restrictions and additional requirements may apply to transactions with governmental or public entities. At the end of the contract, the customer may renew the contract or return the equipment to DFS.
2. Dell Technologies has recovered 2.8 billion pounds of electronics since 2007. Source: Based on Dell internal analysis of publicly available data, April 2023.
3. Based on a Forrester Total Economic Impact™ Study Commissioned by Dell Technologies and AMD, "The Total Economic Impact™ Of Dell Premier," February 2024. Full study: The Total Economic Impact™ of Dell Premier.